

PLAN SHOWING THE PROPOSED RESIDENTIAL BUILDING AT S.NO.98/2PT,(S.NO.98/2C AS PER PATTA) AT MADURAVOYAL VILLAGE & TOWN PANCHAYAT, SAIDAPET TALUK, CHENGAI M.G. R. DISTRICT

SCALE 1"-8'0"(1:100)

**AREA DETAILS**

|                 |   |                              |
|-----------------|---|------------------------------|
| TOTAL PLOT AREA | = | 2400 Sq. Ft. (223.08 Sq. M)  |
| BUILT UP AREA   | = | 812.00 Sq. Ft. (75.43 Sq. M) |
| P. S. I.        | = | 0.33                         |
| PLOT COVERAGE   | = | 38.50 %                      |
| PORCH AREA      | = | 127.50 Sq. Ft. (11.84 Sq. M) |

**JOINERY DETAILS**

|                |            |             |               |
|----------------|------------|-------------|---------------|
| D              | DOOR       | 3'3" x 7'0" | (1.0 x 2.14)  |
| D <sub>1</sub> | DOOR       | 3'0" x 2'0" | (0.91 x 2.14) |
| D <sub>2</sub> | DOOR       | 2'6" x 7'0" | (0.76 x 2.14) |
| W <sub>1</sub> | WINDOW     | 5'0" x 4'6" | (1.52 x 1.37) |
| W              | WINDOW     | 6'0" x 4'6" | (1.83 x 1.37) |
| V              | VENTILATOR | 3'0" x 2'0" | (0.91 x 0.61) |

**COLOUR INDEX**

|  |               |  |      |
|--|---------------|--|------|
|  | PROPOSED      |  | ROAD |
|  | SITE BOUNDARY |  |      |

N. Ramarena  
OWNER

R. PAGUTHARIVU, D.C.E., D.C.T.,  
LICENSED SURVEYOR,  
CORPORATION OF MADRAS,  
REG NO. 96  
Office: 10, Venkateshwara Avenue,  
SABARI NAGAR, PORUR-116.

LICENSED SURVEYOR

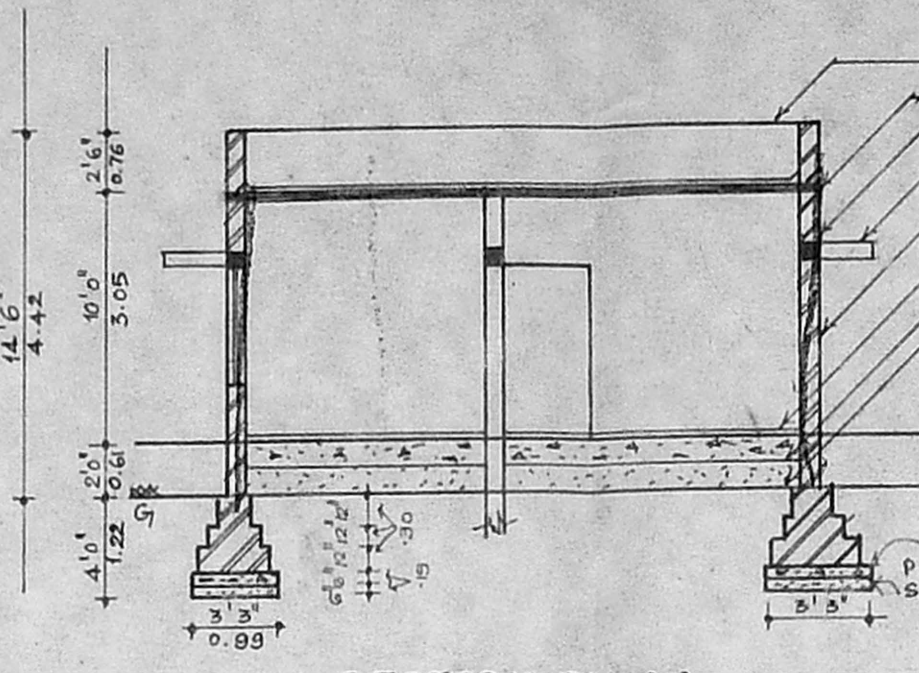

A/20278/164/96

Planning Permit No. **APPROVED**

SUBJECT TO THE CONDITIONS IN THIS OFFICE LETTER

No. A/24804/96/2C/96

MADURAVOYAL VILLAGE SETTLEMENT

FOR MEMBER SECRETARY  
MADRAS METROPOLITAN DEVELOPMENT AUTHORITY  
MADRAS - 600 008.

